

A3TS or A3TS/SS

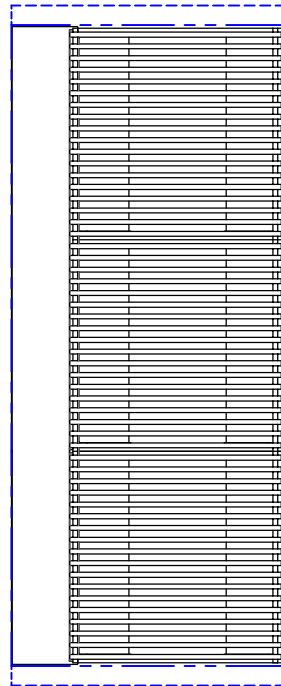

LAZYSMAN A3TS or A3TS/SS
OPEN HEARTH GRILL
INSTALLATION METHOD #1
GAS PIPING ROUTED TO REAR
ISLAND CUTOUT IN BLUE

TOP VIEW



SCALE: 1:1

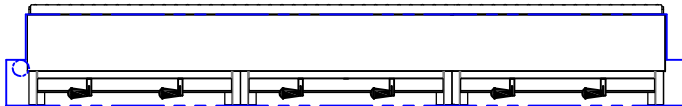

FRONT VIEW

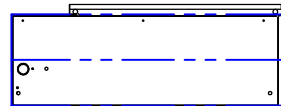

RIGHT SIDE VIEW



LAZYMEN A3TS or A3TS/SS
OPEN HEARTH GRILL
ISLAND CUTOUT
INSTALLATION METHOD #1
GAS PIPING ROUTED TO REAR

SCALE: 1:1

TOP VIEW

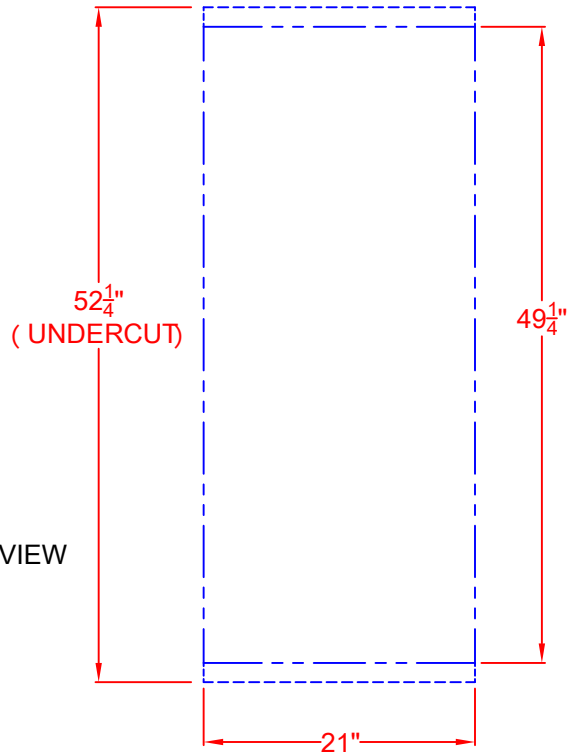

FRONT VIEW

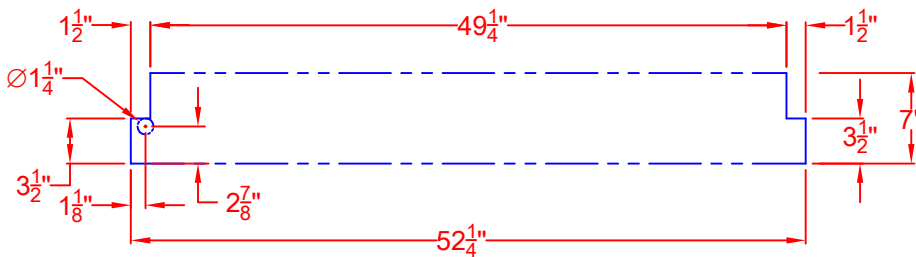

RIGHT SIDE VIEW

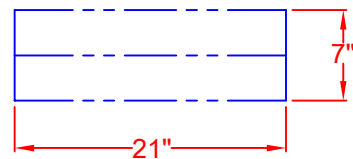



LAZYMEN A3TS or A3TS/SS
OPEN HEARTH GRILL
INSTALLATION METHOD #2
GAS PIPING ROUTED
STRAIGHT DOWN
ISLAND CUTOUT IN BLUE

SCALE: 1:1

TOP VIEW

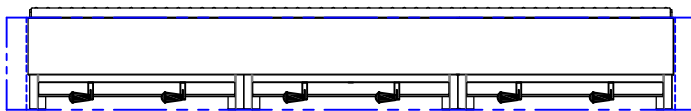
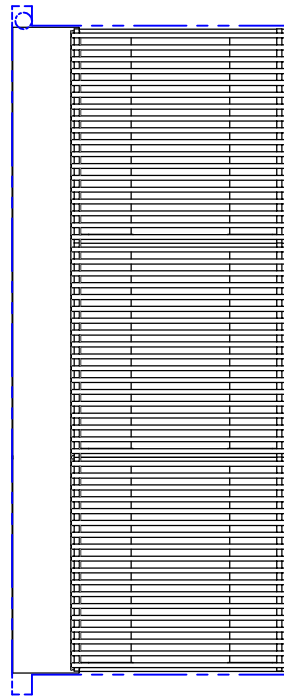

FRONT VIEW



RIGHT SIDE VIEW



LAZYMEN A3TS or A3TS/SS
OPEN HEARTH GRILL
ISLAND CUTOUT
INSTALLATION METHOD #2
GAS PIPING ROUTED
STRAIGHT DOWN

SCALE: 1:1

TOP VIEW

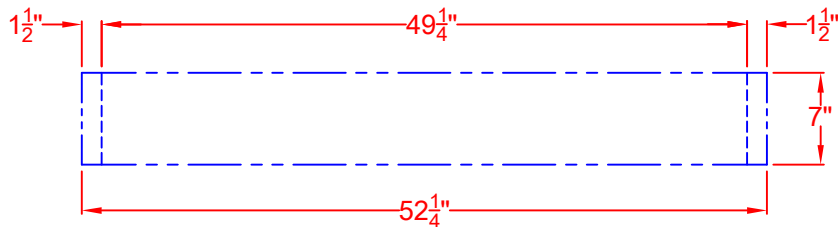
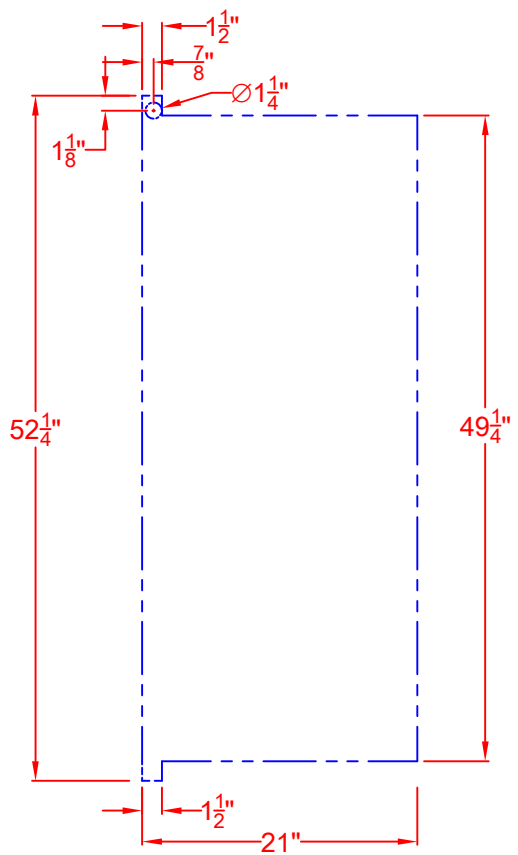

FRONT VIEW

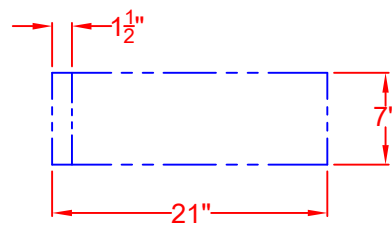

RIGHT SIDE VIEW



LAZYSMAN A3TS or A3TS/SS
OPEN HEARTH GRILL
WITH DIMENSIONS

SCALE: 1:1

TOP VIEW

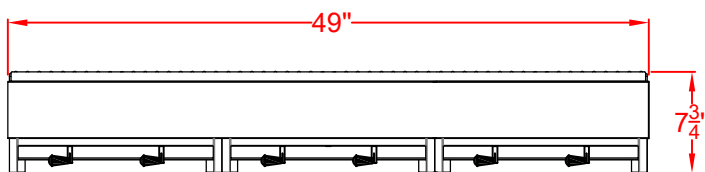
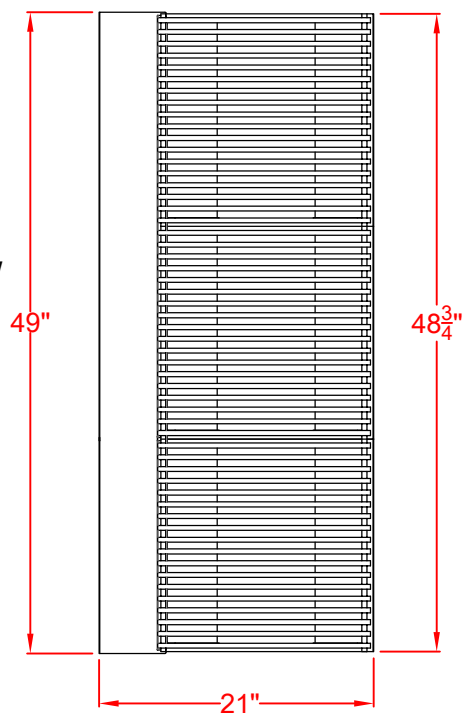

FRONT VIEW

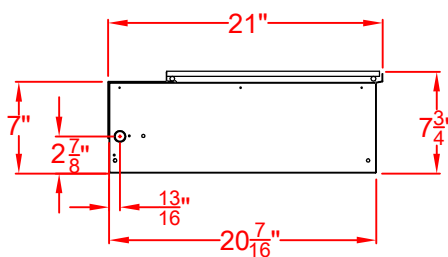

RIGHT SIDE VIEW