

Lazy Man



LazyMan Gourmet Outdoor Kitchen

616 Hardwick Street • P. O. Box 327 • Belvidere, NJ 07823

800.475.1950 • 908.475.5315 • Fax: 908.475.3165

www.lazyman.com

Models, specifications and prices subject to change without notice



In 1932, Louis McGlaughlin launched what would become the gas barbecue industry by started the Chicago Combustion Company. During those early years, Louis focused on building gas burners for commercial and industrial applications. The most famous of those burners was the ARGIL. Soon he found that his burners were being adopted for commercial cooking. After moving to New York, Louis incorporated new ideas and improved on his burner by building our first successful gas-fired broiler called the BROILBURGER.

Until the mid-1950's, the gas grill business was almost exclusively found in commercial cooking. The first ever portable gas grills were sold in 1954 by Chicago Combustion Corporation. Shortly after, two other companies, Charmglo and Falcon, released competing portable grills. Based on the premise of the successful gas fired BROILBURGER, these portable gas fired barbecues featured state of the art burners. The burners were built from the lineage of burner technology that formed the basis of the Chicago Combustion Company. Other early design ideas included porcelain on steel fire boxes, electric rotisseries, and lava rocks to emulate the charcoal flavor. Don McGlaughlin, Louis' son needed a source of fuel for their new portable grill. The iconic propane bottle that we now associate with the grilling today was actually sourced from the 20-lb propane cylinders used by plumbers. In 1959 you could purchase our portable Model AP for \$131.25.

Over the next 30 years, Chicago Combustion continued to develop new models such as the Masterpiece Series which is a more "traditional" gas grill. We slowly exited the mass retail business in favor of selling handcrafted gourmet grills by our network of distributors who offer high touch sales, service and support. With this evolution, we decided it was time to rebrand the company and became LazyMan. LazyMan comes from our earliest grill line whose name was inspired by how much easier gas grilling was compared the charcoal of the time.

What sets LazyMan apart from other companies is our attention to quality and durability. Our parts are made from the absolute highest quality materials. All of our stainless steel burners, fireboxes, grates, hoods, shelves and drip pans are made in our factory in Belvidere, New Jersey. The handmade quality craftsmanship is apparent from the first day you received your product to every time you use your grill for the next 40 years. We are extremely proud to say that we stand behind every single grill we have ever made. To this day, more than 80 years since we were founded, we sell replacement parts for every product we have ever made.

For more information, call **800.475.1950** or visit us on the web at **www.lazyman.com**

LM210 Masterpiece Mobile Series with Custom Carts



LM210-40/20 MC
4 broiler burners & 1 surface burner



LM210-28/20 MC
3 broiler burners & 1 surface burner



- ◆ The Original All Stainless Steel Outdoor Barbecue with all stainless steel construction that lasts a lifetime.
- ◆ Stainless steel components are durable, easy to clean and will not rust - ideal for salt air environment!
- ◆ Stainless steel cooking hood with thermometer included.
- ◆ Available in 4 models:
 - **LM210-40MC** with 4 broiler burners.
 - **LM210-28MC** with 3 broiler burners.
 - **LM210-40/20MC** with 4 broiler burners & 1 surface burner.
 - **LM210-28/20MC** with 3 broiler burners & 1 surface burner.
- ◆ Mobile cart enclosed with access doors to storage and two stainless steel side shelves.
- ◆ Internal gas piping and fittings included for easy connection to gas supply. Available for either LP gas or Natural Gas. *Please specify when ordering.*
- ◆ Piezo-electric ignition for easy, safe, reliable starting.
- ◆ Fast start-up from independently controlled 22,000 Btu burners ensure professional cooking results.
- ◆ Heavy duty rubber tire wheels for ease of mobility on 2 straight wheels and 2 swivel wheels with locking casters.
- ◆ Completely assembled at the factory before shipping. Unpack and cook!
- ◆ Available options include: grate upgrade, custom broiler burner/surface burner configurations and vinyl covers.

| MODEL | BURNERS | BTU'S | OVERALL DIMENSIONS | GRILLING AREA | SHIP WT. |
|----------------------|--------------------------------------|--------|--------------------|---------------|----------|
| LM210-28MC | 3 Broiler Burners | 36,000 | 24" x 55½" x 48" | 24" x 15" | 300 lbs. |
| LM210-40MC | 4 Broiler Burners | 48,000 | 24" x 67½" x 48" | 36" x 15" | 375 lbs. |
| LM210-28/20MC | 3 Broiler Burners & 1 Surface Burner | 48,000 | 24" x 71½" x 48" | 24" x 15" | 310 lbs. |
| LM210-40/20MC | 4 Broiler Burners & 1 Surface Burner | 60,000 | 24" x 83½" x 48" | 36" x 15" | 410 lbs. |

LM210 Mobile Series

- ◆ Superior construction using commercial quality, professional grade Type 304 Stainless Steel.
- ◆ Stainless Steel SS Class cooking hood with full width polished stainless steel comfort cool handle.
- ◆ A 750 degree thermometer is standard.
- ◆ 115 volt electric rotisserie with heavy-duty spit rod is standard on mobile models and optional on others.
- ◆ Stainless steel cooking grates are rods welded and are designed for easy cleaning.
- ◆ Internal gas piping and fittings for convenient rear connection to natural or propane gas.
- ◆ Two large stainless steel side shelves with built in lifting handles.
- ◆ Slide out stainless steel drip pan in each surface burner and barbecue module.
- ◆ Individual precise burner control.
- ◆ Lower stainless steel storage shelf is standard.
- ◆ Available in 28" or 40" wide barbecue modules with four different surface burner configurations.
- ◆ Heavy-duty nylon wheels with rubber tires for ease of mobility.
- ◆ Comes fully assembled and ready to use.



LM210-40/30M
4 broiler burners & 2 surface burners

| MODEL | NUMBER & TYPE OF BURNERS | BTU's | OVERALL DIMENSIONS | WEIGHT |
|---------------|---|---------|--------------------|----------|
| LM210-28M | 3 broiler burners | 36,000 | 24" x 55½" x 46½" | 237 lbs. |
| LM210-28/20M | 3 broiler burners & 1 surface burner | 48,000 | 24" x 71½" x 46½" | 283 lbs. |
| LM210-28/28M | 3 broiler burners & 3 broiler burners side-by-side | 72,000 | 24" x 76½" x 46½" | 440 lbs. |
| LM210-282820M | 3 broiler burners & 3 broiler burners side-by-side & 1 surface burner | 84,000 | 24" x 96½" x 46½" | 480 lbs. |
| LM210-202820M | 3 broiler burners & 1 single surface burner on each end | 60,000 | 24" x 85½" x 46½" | 300 lbs. |
| LM210-204020M | 4 broiler burners & 1 single surface burner on each end | 108,000 | 24" x 85½" x 46½" | 300 lbs. |
| LM210-28/30M | 3 broiler burners & 2 surface burners | 60,000 | 24" x 83½" x 46½" | 342 lbs. |
| LM210-30M | 2 surface burners | 24,000 | 24" x 45½" x 46½" | 190 lbs. |
| LM210-30/20M | 2 surface burners & 1 surface burner | 36,000 | 24" x 57½" x 46½" | 230 lbs. |
| LM210-30/30M | 2 surface burners & 2 surface burners | 48,000 | 24" x 57½" x 46½" | 260 lbs. |
| LM210-40M | 4 broiler burners | 48,000 | 24" x 67½" x 46½" | 300 lbs. |
| LM210-40/20M | 4 broiler burners & 1 single surface burner | 60,000 | 24" x 83½" x 46½" | 355 lbs. |
| LM210-40/30M | 4 broiler burners & 2 surface burners | 72,000 | 24" x 96½" x 46½" | 400 lbs. |
| LM210-403028M | 4 broiler burners & 2 surface burners & 3 broiler burners | 108,000 | 24" x 12¼" x 46½" | 520 lbs. |
| M210-40/40M | 4 broiler burners & 4 broiler burners side-by-side | 96,000 | 24" x 83½" x 46½" | 550 lbs. |



LM210-40/30M
4 broiler burners & 2 surface burners



LM210-40M
4 broiler burners and equipped with optional Red-Ray Radiant Burners

Masterpiece Series Accessories

| | MODEL | DESCRIPTION | SHIP WT. |
|---|--|--|---|
|  | AC-115V | 115 volt Rotisserie Motor | 4 lbs. |
| | AC-12H | 12' Hose with Fittings | 2 lbs. |
| | AC-12QD | 12' Hose with Quick Disconnect Fittings | 2 lbs. |
| | AC-2028 | Heavy Duty Vinyl Cover for LM210-28M | 6 lbs. |
|  | AC-2028/20 | Heavy Duty Vinyl Cover for LM210-28/20M | 7 lbs. |
| | AC-2028/28 | Heavy Duty Vinyl Cover for LM210-28/28M | 8 lbs. |
| | AC-2028/30 | Heavy Duty Vinyl Cover for LM210-28/30M | 8 lbs. |
| | AC-2040 | Heavy Duty Vinyl Cover for LM210-40M | 7 lbs. |
| | AC-2040/20 | Heavy Duty Vinyl Cover for LM210-40/20M | 8 lbs. |
| | AC-2040/30 | Heavy Duty Vinyl Cover for LM210-40M/30M | 9 lbs. |
| | AC-2040/30/28 | Heavy Duty Vinyl Cover for LM210-40/30/28M | 14 lbs. |
| | AC-21028BI | Vinyl Rolltop Cover for Built-In LM210-28 | 8 lbs. |
| | AC-21040BI | Vinyl Rolltop Cover for Built-In LM210-40 | 8 lbs. |
| | AC-JACKET/30 | HD Vinyl Jacket for 30# LP Cylinder | 8 lbs. |
|  | AC-RAK | Stainless Steel Rib Rak | 9 lbs. |
| | AC-SSCH28BI | Vinyl SS Class Cover for Built-In LM 210-28 | 8 lbs. |
| | AC-SSCH40BI | Vinyl SS Class Cover for Built-In LM 210-40 | 9 lbs. |
| | MB/LEG | Patio Stainless Steel Legs (2) Kit and hardware | 5 lbs. |
| | MBLC-28 | Stainless Steel Mobile Cart for LM210-28 | 82 lbs. |
| | MBLC-40 | Stainless Steel Mobile Cart for LM210-40 | 114 lbs. |
| | SSCC/210-28 | Rolltop Stainless Steel Cooking Hood for LM210-28 | 25 lbs. |
| | SSCC/210-28ROT | Rolltop 115 volt Rotisserie Assembly for LM210-28 | 6 lbs. |
| | SSCC/210-40 | Rolltop Stainless Steel Cooking Hood for LM210-40 | 32 lbs. |
| | SSCC/210-40ROT | Rolltop 115 volt Rotisserie Assembly for LM210-40 | 7 lbs. |
| | SSCD | SS Class Drawer, ID 14" W x 20" D x 5 1/2" H | 16 lbs. |
| | SSCH28 | SS Class Cooking Hood for LM210-28 Mobile | 33 lbs. |
| | SSCH28R | SS Class Rotisserie & 115v Motor - LM210-28M | 5 lbs. |
| | SSCH40 | SS Class Cooking Hood for LM210-40 Mobile | 44 lbs. |
| | SSCH40R | SS Class Rotisserie & 115v Motor -LM210-40M | 8 lbs. |
| | 210-28/AROV | Free Standing 115 volt Rotisserie for LM210-28 only | 8 lbs. |
| | 210-40/AROV | Free Standing 115 volt Rotisserie for LM210-40 only | 14 lbs. |
| |  | TR210 | Stainless Steel Toasting/Step-Up Rack for LM210 |
| MB/SS | | Mobile Base Stainless Steel Shelf | 9 lbs. |
| SS-210 | | Stainless Steel Sides | 4 lbs. |
| SSIK-28 | | Stainless Steel Insulation Kit for LM210-28 Built-In | 28 lbs. |
| SSIK-40 | | Stainless Steel Insulation Kit for LM210-40 Built-In | 36 lbs. |
| SSIK-20 | | Stainless Steel Insulation Kit for LM210-20 Built-In | 19 lbs. |
| SSIK-30 | | Stainless Steel Insulation Kit for LM210-30 Built-In | 30 lbs. |
| SSS-2 | | Spacer, for side-by-side wood installations | 3 lbs. |
| SS/SP/210 | | Stainless Steel Spatula | 1 lb. |

RED-RAY Radiant Burners

- ◆ Sears, seals and slow cooks roasts and poultry with super heated radiant cooking.
- ◆ Available in two standard sizes as a retrofit or factory-attached to a new Lazy Man Mobile gas barbecue.
- ◆ Replaces SS class hood assembly and adds control panel affixed to the rear of the left workshelf.
- ◆ 115 volt electric rotisserie with heavy-duty spit rod.



| 210 Rotisserie Burner Upgrades | | BTU's |
|--------------------------------|--|--------|
| SSRR28SUB | Substitute RED-RAY Radiant Rotisserie Burner Cooking Hood on LM210-28M Barbecue | 6,000 |
| SSRR40SUB | Substitute RED-RAY Radiant Rotisserie Burner Cooking Hood on LM210-40M Barbecue | 12,000 |

Masterpiece Series Parts



Shown above is the #2117 - Masterpiece Stainless Steel Renewal Kit for LM210-28, consisting of:

1. 2121 Premium 210 SS Rod Cook Grates (2)
2. 2113 Stainless Steel Baffle
3. 2106 Stainless Steel Insert (stove box)
4. 2110 Full Set Permanent Coals (lava rock)
5. 2109 Stainless Steel Coal Grates (2)
6. 2103 Spark Ignited Lead Wire
7. 2108 Stainless Steel Collector Box and Electrode
8. 2106A Stainless Steel Flash Tubes
9. 2107 Stainless Steel Burners (3)



Parts for LM210-28

| MODEL | DESCRIPTION |
|-------|--|
| 2116 | Front Label |
| 2113 | Stainless Steel Baffle for LM210-28 |
| 2112 | Flat Stainless Steel Weather Cover |
| 2121 | Premium 210 SS Rod Cook Grates (2 pcs.) |
| 2109 | Magic 210 Flame Grate System |
| 2109B | BroilRite SS Flavor Enhancers |
| 2108 | Stainless Steel Collector Box & Electrode |
| 2107 | Stainless Steel Burners (3 per set) |
| 2106 | Stainless Steel Insert |
| 2106A | Stainless Steel Bar Upgrade |
| 2104 | Gas Supply Manifold and three (3) valves |
| 2104B | Control Knob |
| 2103 | Spark Igniter with Lead |
| 2102 | Stainless Steel Chassis |
| 2101 | Stainless Steel Drip Collector Pan |
| 2117 | Masterpiece Stainless Steel Renewal Kit for LM210-28 Consists of: 2106, 2113, 2106A, 2107, 2108, 2109, B 2121 & 2103 |

Parts for LM210-40

| MODEL | DESCRIPTION |
|-------|--|
| 4016 | Front Label |
| 4013 | Stainless Steel Baffle for LM210-40 |
| 4012 | Flat Stainless Steel Weather Cover |
| 4021 | Premium 210 SS Rod Cook Grates (3 pcs.) |
| 4009 | Magic 210 Flame Grate System |
| 4009B | Broil Rite Flavor Enhancers |
| 4008 | Stainless Steel Collector Box & Electrode |
| 4007 | Stainless Steel Burners (4 per set) |
| 4006 | Stainless Steel Insert |
| 4006A | Stainless Steel Flash Bar Upgrade |
| 4004 | Gas Supply Manifold and four (4) valves |
| 4004B | Control Knob |
| 4003 | Spark Igniter with Lead |
| 4002 | Stainless Steel Chassis |
| 4001 | Stainless Steel Drip Collector Pan |
| 4017 | Masterpiece Stainless Steel Renewal Kit for LM210-40 Consists of: 4006, 4013, 4006A, 4007, 4008, 4009, 4021 & 4003 |

LM210 Masterpiece Series Custom Burner Configurations

- ◆ Lazy Man can design a custom outdoor cooking center just for you and make your backyard the talk of the neighborhood.
- ◆ Custom configurations are available for either our 210 Masterpiece Series Mobile models or our 210 Masterpiece Series Built-In Models.
- ◆ Choose from one of our most popular combinations or we'll help you create your own design, customized just for you!
- ◆ Give us a call today and we'll help you create your own custom designed cooking center for your deck or patio.



Custom Design features LM-210-28 with 3 Broiler Burners and LM210-20 with 1 Surface Burner

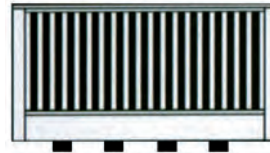

210-40

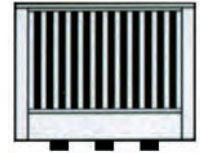

210-28

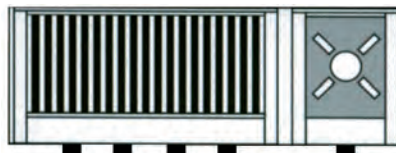

210-40/20



210-20

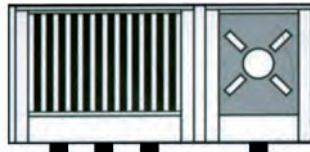

210-28/20

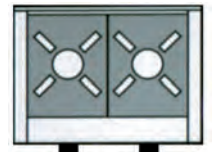

210-30



Custom Design features LM-210-40 with 4 Broiler Burners and LM210-30 with 2 Surface Burners

| Built-In Model | Overall Dimensions | Grill Area | Shipping Weight |
|----------------|--------------------|------------|-----------------|
| 210-40/20 | 58" x 21" x 12" | 36" x 15" | 127 lbs. |
| 210-40 | 40" x 21" x 12" | 36" x 15" | 99 lbs. |
| 210-28/20 | 44" x 21" x 12" | 24" x 15" | 97 lbs. |
| 210-28 | 28" x 21" x 12" | 24" x 15" | 69 lbs. |
| 210-30 | 28" x 21" x 12" | n/a | 48 lbs. |
| 210-20 | 16" x 21" x 12" | n/a | 28 lbs. |



One of our Most popular models. This Custom Design features LM-210-40 with 4 broiler burners and LM-210-30 with 2 surface burners in a Mobile unit.

Built-In Models and Mobile Models are Available in Natural Gas or LP Gas. Please Specify When Ordering.



Custom Design features LM-210-40, LM210-30 and LM210-28 in a Mobile unit

| Mobile Model | Overall Dimensions | # and Type of Burners | Shipping Weight |
|--------------|--------------------|-----------------------|-----------------|
| 210-40/30M | 24" x 95½" x 46½" | 4 Broiler & 2 Surface | 400 lbs. |
| 210-40/20M | 24" x 83½" x 46½" | 4 Broiler & 1 Surface | 355 lbs. |
| 210-40M | 24" x 67½" x 46½" | 4 Broiler | 300 lbs. |
| 210-28/20M | 24" x 71½" x 46½" | 3 Broiler & 1 Surface | 283 lbs. |
| 210-28M | 24" x 55½" x 46½" | 3Broiler | 237 lbs |

210 Masterpiece Series Built-Ins



Custom Patio Built-In showing LM-210-30 with 2 Surface Burners on the left and LM210-40 with 4 Broiler Burners on the right.



Model 210-28
3 burner broiler



Model 210-40
4 burner broiler



Model 210-20
1 surface burner



Model 210-30
2 surface burners

210 Masterpiece Built-In Series

| MODEL NUMBER | NUMBER & TYPE OF BURNERS | TOTAL BTU'S | OVERALL DIMENSIONS | SHIPPING WEIGHT |
|--------------|--------------------------|-------------|--------------------|-----------------|
| LM210-28 | 3 broiler burners | 36,000 | 28" x 21" x 12" | 85 lbs. |
| LM210-40 | 4 broiler burners | 48,000 | 40" x 21" x 12" | 110 lbs. |
| LM210-20 | 1 surface burner | 12,000 | 16" x 21" x 12" | 30 lbs. |
| LM210-30 | 2 surface burners | 24,000 | 28" x 21" x 12" | 48 lbs. |

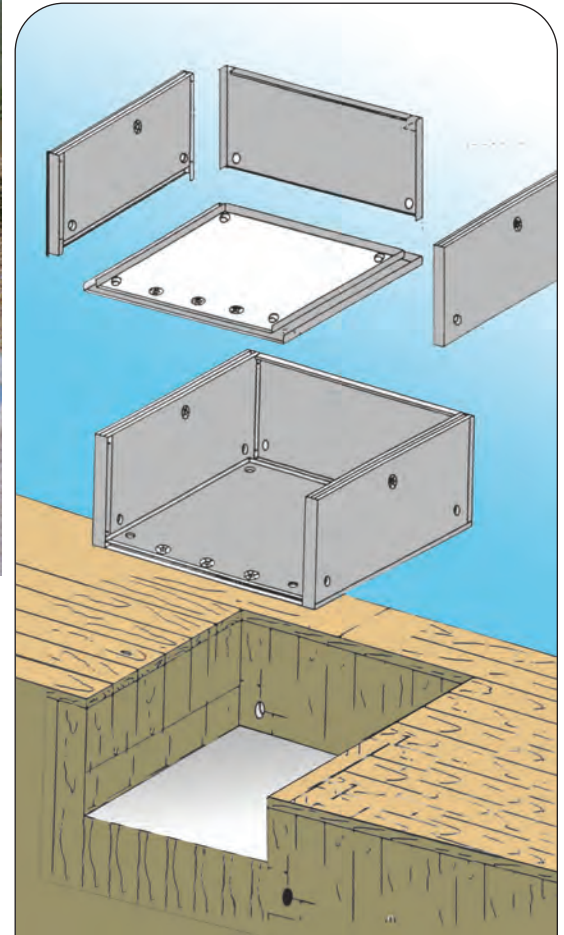

MASTERPIECE SERIES INSULATION PANELS

Allows for barbecue units to be installed in outdoor wood structures. Sizes available for any combination of Masterpiece Series Built-Ins. Spacers are available for side-by-side wood installations. Must be used in open area.

FOR OUTDOOR USE ONLY

Built-In Models are Available in
Natural Gas or LP Gas.
Please Specify When Ordering.

- ◆ Independently controlled burners allow you to control the heat for professional cooking results.
- ◆ Family sized cooking area designed to suit your needs.
- ◆ Broil Rite Stainless Steel Flavor Enhancers offer a unique heat distribution system that radiates heat evenly.
- ◆ Stainless Steel weather cover and Piezo-electric ignition for safe, easy start-ups.
- ◆ Easy to clean stainless steel surfaces.
- ◆ Create your own grilling area with any combination of broiler and surface burners.
- ◆ Mix and match any unit within masonry construction or within wood construction using insulation kits and spacers.

Open Hearth Series Built-Ins

The Lazy Man Model A Series Barbecues are designed to give you complete cooking control. The Model A Series Open Hearth gas broilers have Stainless Steel Type 304 construction chassis, insert pan, drip pan and cooking grates. Models feature two burners per section and are available in sizes from 17" to 68" wide. These grills ship with natural lava rock and are completely assembled.

The A1TS through A4TS Series Open Hearth gas broilers have been designed for built-in outdoor installations in masonry or other non-combustible materials - **not in wood!** Sides and back of units are subject to discoloration. TS units use 1/2" I.P.S. gas connection.

The A1TS/SS through A4TS/SS Series Open Hearth gas broilers are **NOT** been designed for use as built-ins. The front, sides and back are covered in Type 304 polished stainless steel. These units should be installed on a non-combustible surface - **not on wood.** TS/SS units use 1/2" I.P.S. gas connection.



Shown is the A4TS with 2 section Stainless Steel Hood.

| Specifications | A1TS A1TS/SS | A2TS A2TS/SS | A3TS A3TS/SS | A4TS A4TS/SS |
|-----------------------------|-------------------|-------------------|-----------------|-----------------|
| # of Burners: | 2 | 4 | 6 | 8 |
| Width: | 16 1/2" | 33" | 49 1/4" | 65 1/2" |
| Depth: | 21" | 21" | 21" | 21" |
| Height: | 7 7/8" | 7 7/8" | 7 7/8" | 7 7/8" |
| Cooking Area: | 16 1/4" x 16 1/4" | 16 1/4" x 32 1/2" | 16 1/4" x 49" | 16 1/4" x 65" |
| Cooking Area Square Inches: | 264 | 528 | 792 | 1,056 |
| Ship Wt. A-TS: | 42 lbs. | 85 lbs. | 126 lbs. | 170 lbs. |
| Ship Wt. AT/SS: | 52 lbs. | 95 lbs. | 136 lbs. | 170 lbs. |



Model A1TS
Model A1TS/SS



Model A4TS
Model A4TS/SS



Model A2TS
Model A2TS/SS



Model A3TS
Model A3TS/SS

Country Club Series

The Country Club Series features a large, portable, heavy-duty gas broiler with an attractive combination of stainless steel and wrought iron work. The freestanding units are equipped with rubber tire wheels for easy mobility and feature quick connection for either natural gas or propane. These barbecues are pressure tested at the factory, ship completely assembled and ready to use right out of the box.

All Country Club Series models feature:

- ◆ Stainless Steel type 304 work shelf
- ◆ Stainless Steel firebox
- ◆ Stainless Steel cooking tops
- ◆ Stainless Steel burner tubes available as an upgrade
- ◆ Stainless Steel drip pans
- ◆ 2 Burners per section
- ◆ 20,000 Btu's per burner
- ◆ Black handle brass valves
- ◆ Rubber tire nylon wheels
- ◆ Heavy duty wrought iron mobile base
- ◆ Available in Natural Gas or LP models
- ◆ Lava rock included
- ◆ Comes completely assembled
- ◆ Cast Iron Grates available for enhanced cooking
- ◆ Hoods, rotisseries and vinyl covers available

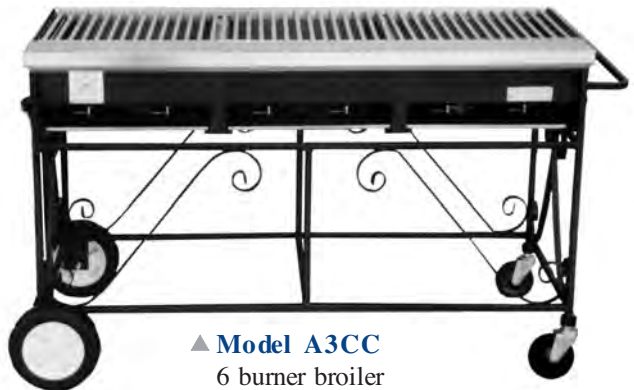

| SPECIFICATIONS | A2CC | A3CC | A4CC |
|-----------------------|-------------|------------|------------|
| # of Burners: | 4 | 6 | 8 |
| Width: | 38" | 52" | 72" |
| Depth: | 23" | 23" | 23" |
| Height: | 31" | 31" | 31" |
| Cooking Area: | 16¼" x 32¼" | 16¼" x 49" | 16¼" x 65" |
| Cooking Area-sq. in.: | 528 | 792 | 1,056 |
| Shipping Weight: | 135 lbs. | 195 lbs. | 250 lbs. |

Model A & Country Club Series Parts & Accessories

Model A Series Schematic
1 Section shown

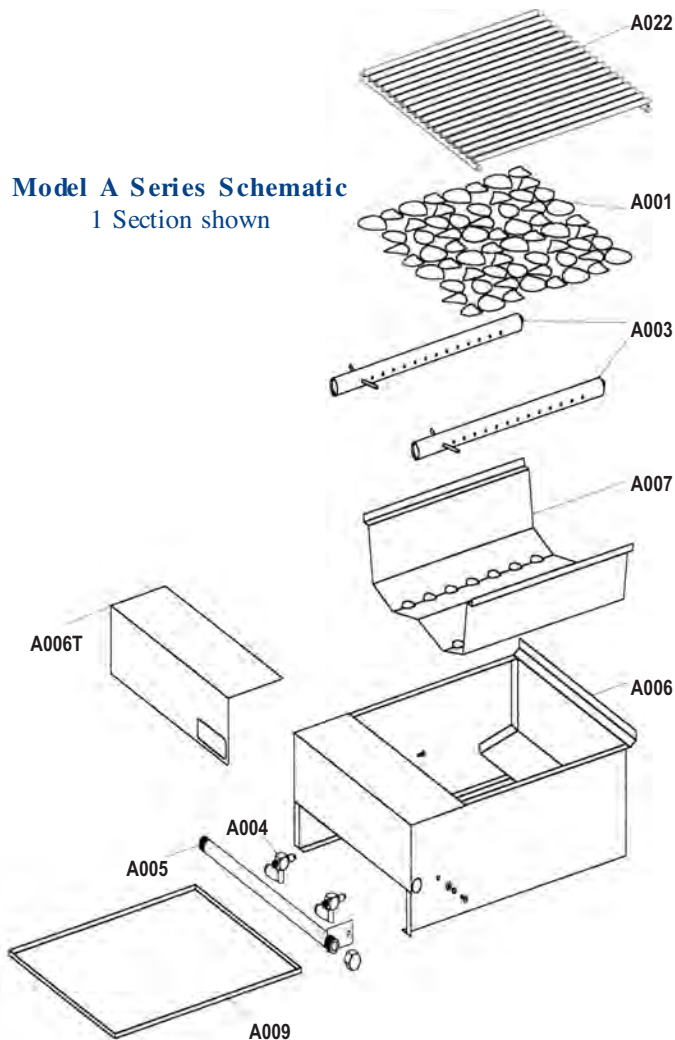

RibRak with HOT ROD grate offers two positions to select before cooking - Level or Slanted with Drip Tray.



FACC Hoods are available for all Model A and Country Club Barbecues.

Accessories

| MODEL | DESCRIPTION |
|--------------|--|
| FACC | FA Rolltop Stainless Steel 1 Section Cooking Cover |
| FACC2 | FA Rolltop Stainless Steel 2 Section Cooking Cover |
| FACC3 | FA Rolltop Stainless Steel 3 Section Cooking Cover |
| FACC4 | FA Rolltop Stainless Steel 4 Section Cooking Cover |
| B60-A* | Substitute Three Ring Range-Type Big 60 Burner |
| A0003SSR* | Substitute Optional Stainless Steel Burner Tube |
| A-RO | Free Standing Electric Rotisserie, 1 Section |
| A-ROS | Free Standing Electric Rotisserie w/SS Windshield |
| A-ROS2 | F/S Electric Rotisserie w/SS Windshield, 2 section |
| TR-A | Stainless Steel Toasting/Step Up Rack, 1 section |
| A002CI | Cast Iron Cooking Grate |
| A002CIR* | Substitute Case Iron Cooking Grate |
| SWC-A | Flat Stainless Steel Weather Cover for 1 Section |
| SS/SP | Stainless Steel Spatula |
| H/LPR | 6' Hose and Propane Regulator |
| AC-JACKET/30 | HD Vinyl Jacket for 30# Propane Cylinder |
| AC-BMSG | BIG MAC Steel Griddle Plate, 16" x 40" x 4" |
| AC-A2SR | Model A 2 stage-Propane Regulator |
| AC-LPR | Propane Regulator - Low Pressure |
| AC-5H | 5' UL Listed Hose with Fittings |
| AC-6H | 6' UL Listed Hose with Fittings |
| AC-6QD | 6' Quick Disconnect Hose for Natural Gas |
| AC-6QD-1/2 | 6' Hose with 1/2" Quick Disconnect Connection |
| AC-12QD | 12' Quick Disconnect Hose for Natural Gas |
| AC-RAK | Stainless Steel Rib Rak with HOT ROD Grate |
| AC-VA2CC | HD Vinyl Cover for A2CC, 37" x 23" x 24" |
| AC-VA3CC | HD Vinyl Cover for A3CC, 54" x 23" x 24" |
| AC-VA4CC | HD Vinyl Cover for A4CC, 70" x 23" x 24" |
| AC-VA2CC/SSE | HD Vinyl Cover for A2CC/SSE, 58" x 25" x 24" |
| AC-VA3CC/SSE | HD Vinyl Cover for A3CC/SSE, 74" x 25" x 24" |
| AC-VA4CC/SSE | HD Vinyl Cover for A4CC/SSE, 90" x 25" x 24" |

*THESE OPTIONS MUST BE FACTORY INSTALLED AT TIME OF MANUFACTURE

Parts

| MODEL | DESCRIPTION |
|--------|--|
| A001 | Permanent Lava Rock (proper amount for each section) |
| A002CI | Cast Iron Cooking Grate |
| A022 | Stainless Steel HOT ROD Cooking Grate |
| A003 | Standard Burner Tube |
| A003SS | Stainless Steel Burner Tube |
| A004 | Black Handle Brass Valve |
| A005-1 | Pipe Manifold - 1 Section |
| A005-2 | Pipe Manifold - 2 Sections |
| A005-3 | Pipe Manifold - 3 Sections |
| A005-4 | Pipe Manifold - 4 Sections |
| A006 | Stainless Steel 1 Section Broiler Body |
| A006-2 | Stainless Steel 2 Section Broiler Body |
| A006-3 | Stainless Steel 3 Section Broiler Body |
| A006-4 | Stainless Steel 4 Section Broiler Body |
| A007 | Stainless Steel Burner Insert Pan - No cut (single) |
| A007-E | Stainless Steel Burner Insert Pan - Cut one side (end) |
| A007-M | Stainless Steel Burner Insert Pan - Cut two sides (middle) |
| A009 | Stainless Steel Drip Pan, Model A |
| A010 | Stainless Steel Range Top for Big 60 Section |
| A011 | Swivel Caster for Country Club Wheel |
| A012 | Country Club Wheel |
| A014 | Stainless Steel Divider Cap for Model A |
| A-TH | Tank Holder for Model A |

Stainless Steel Elite Series

These units feature Stainless Steel Type 304 heavy duty construction chassis, insert pans, drip pans, burners, cooking grates, side shelves, storage shelf, a mobile base, heavy duty wheels and natural lava rock. Ships completely assembled and ready for use. Hose and regulator not included.



A4SSE shown with optional 2 section electric Rotisserie and Hood



Model A2CC-SSE
4 burner broiler



Model A3CC-SSE
6 burner broiler



Model A4CC-SSE
8 burner broiler

| SPECIFICATIONS | A2CC-SSE | A3CC-SSE | A4CC-SSE |
|------------------|-------------|-------------|---------------|
| # of Burners: | 4 | 6 | 8 |
| Width: | 56½" | 73" | 89" |
| Depth: | 24¼" | 24¼" | 24¼" |
| Height: | 33" | 33" | 33" |
| Cooking Area: | 16¼" x 324" | 16¼" x 49" | 16¼" x 65" |
| Cooking Area: | 528 sq. in. | 792 sq. in. | 1,056 sq. in. |
| Shipping Weight: | 165 lbs. | 265 lbs. | 355 lbs. |



Vinyl Covers

available for Stainless Steel Elite Series Barbecue Grills and Country Club Series Barbecue Grills.
Grill Covers are made of heavy duty vinyl and are custom fit for each Lazy Man grill.

| SSE SERIES VINYL COVERS | SIZE | WT. |
|-------------------------|-----------------|--------|
| AC-VA2CC/SSE | 58" x 25" x 24" | 6 lbs. |
| AC-VA3CC/SSE | 74" x 25" x 24" | 7 lbs. |
| AC-VA4CC/SSE | 90" x 25" x 24" | 7 lbs. |
| COUNTRY CLUB SERIES | SIZE | WT. |
| AC-VA2CC | 37" x 23" x 24" | 5 lbs. |
| AC-VA3CC | 54" x 23" x 24" | 6 lbs. |
| AC-VA4CC | 70" x 23" x 24" | 7 lbs. |

Minute Glow Series

Three Models to Choose From



- ◆ **MG25 MOBL CUSTOM** has stainless steel cooking cover, storage shelf, enclosed sides and sliding front door that doubles as tray, side shelf and rubber wheels.



- ◆ **MG25 Built-In Model** For masonry installation. All stainless steel construction is low maintenance for a lifetime of cooking pleasure.



- ◆ **MG25MOBL** has stainless steel cooking cover, storage shelf, side shelf and rubber tire wheels.

Minute Glow Mobile Models Feature:

- ◆ Stainless Steel cooking hood is included and attaches and removes easily for cleaning.
- ◆ Stainless Steel mobile cart is completely weather proof and built to withstand any environment.
- ◆ Stainless Steel splatter windshield surround included.
- ◆ Stainless steel full size drip pan included to catch any excess drippings.
- ◆ Stainless cooking grates and coal grates included- no rust or porcelain to chip and lodge in food.
- ◆ Stainless steel handle for easy moving - no wood to discolor, crack or split.
- ◆ Lighting port for easy, reliable lighting.
- ◆ Completely assembled at factory, ready to use right out of the box.
- ◆ MGCC Stainless Steel Cooking Cover is an optional accessory on Built-In model.

| SPECIFICATIONS | MG25 MOBL CUSTOM | MG25 Built-In | MG25 MOBL |
|------------------|------------------|---------------|-------------|
| # of Burners: | 2 | 2 | 2 |
| Total Btu's: | 23,000 | 23,000 | 23,000 |
| Width: | 46" | 24" | 46" |
| Depth: | 20" | 18" | 20" |
| Height: | 43" | 43" | 12" |
| Cooking Area: | 22" x 16" | 22" x 16" | 22" x 16" |
| Cooking Sq. in.: | 358 sq. in. | 358 sq. in. | 358 sq. in. |
| Ship Weight: | 135 lbs. | 63 lbs. | 100 lbs. |

| MODEL | ACCESSORIES & OPTIONS | SHIP WT. |
|----------|--|----------|
| MGCART | Stainless Steel Cart only, for MG25 | 40 lbs. |
| MGCC | Stainless Steel Cooking Cover for Built-In model | 17 lbs. |
| MGWC | Flat Stainless Steel Weather Cover for Built-In | 6 lbs. |
| AC-MG25 | Vinyl Weather Cover for MG25 Mobile | 5 lbs. |
| AC-MGROT | MG115 volt Rotisserie Assembly | 10 lbs. |

Open Hearth Mobile Series

Model A-FTS & model A-PTS have the same construction design as the A-Series including stainless steel cooking grates, two burners with 20,000 Btu's per burner, two controls, lava rock and easy-access drip pan.

| | HEIGHT | WIDTH | DEPTH | AREA | WT. |
|------|--------|-------|-------|-------------|---------|
| AFTS | 31" | 17" | 22" | 16¼" x 16¼" | 72 lbs. |
| APTS | 31" | 17" | 22" | 16¼" x 16¼" | 80 lbs. |



A-FTS

Model AFTS is free standing with a convenient storage shelf and stainless steel work area.

Model APTS is portable with casters and rubber wheels for greater mobility.



A-PTS

Triple Control Utility Stoves



Stainless Steel Triple Ring
Single Burner Utility Stove



Stainless Steel Triple Ring
Double Burner Utility Stove



Triple Ring Double Burner
Utility Stove
shown with extension legs installed



Chef's Mate I
Single Burner Utility Stove



Chef's Mate II
Double Burner Utility Stove

Triple Ring Single Burner
Utility Stove

- ◆ Triple Control Utility Stove has 3 ring cast iron burners.
- ◆ 1-10,000 Btu burner ring, 1-20,000 Btu burner ring and 1-30,000 Btu burner ring for a total of 60,000 Btu's per burner.
- ◆ Stainless Steel Model features all stainless steel Type 304 exterior for long lasting beauty and durability.
- ◆ The rugged durability of the commercial construction provides a lifetime of dependable service.
- ◆ Available in single burner or double burner models. Larger models available upon request.
- ◆ All units include leg extensions for a choice of cooking heights at either 9" or 25".
- ◆ All units include hose. Regulator is **NOT** included.

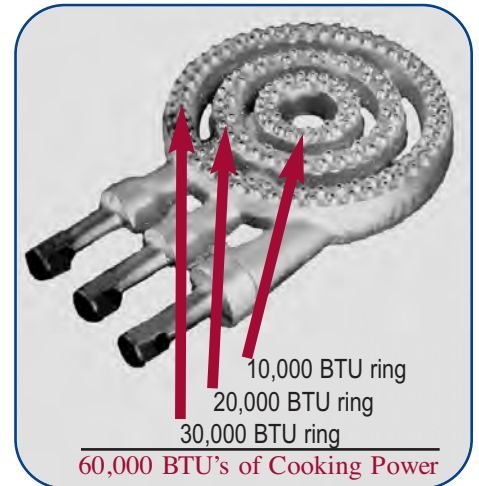

| SPECIFICATIONS | SS Big 60 I | SS Big 60 II | Big 60 I | Big 60 II | CHEF I | CHEF II |
|----------------|-------------|--------------|-----------|-----------|---------|---------|
| # of Burners: | 3 ring | 2-3 ring | 3 ring | 2-3 ring | 1 | 2 |
| Total Btu's: | 60,000 | 120,000 | 60,000 | 120,000 | 18,000 | 36,000 |
| Length: | 16" | 36" | 16" | 36" | 10" | 25" |
| Depth: | 20" | 20" | 20" | 20" | 15" | 15" |
| Height: | 9" or 25" | 9" or 25" | 9" or 25" | 9" or 25" | 8" | 8" |
| Weight: | 54 lbs. | 92 lbs. | 50 lbs. | 90 lbs. | 16 lbs. | 32 lbs. |



Single and Double Burner Utility Stoves can ship UPS

Big 60 Parts

| MODEL | DESCRIPTION |
|--------|--------------------------------|
| 6001 | Set of 3 Valves with Orifice |
| 6001-O | Set of 3 Orifices for Big 60 |
| 6001-V | Valve for Big 60 |
| 6002 | Control Knob for Big 60 |
| 6003 | Pipe Manifold, per section |
| 6004 | #12cCc 3-Ring Burner Assembly |
| 6005 | Set of 4 Steel Grate Fingers |
| 6006 | Steel Body, per Big 60 Section |
| 6007 | Set of Extension Legs |

Utility Stove Accessories

| MODEL # | DESCRIPTION |
|---------|---|
| AC-LPR | Propane Regulator - Low Pressure |
| AC-A2SR | Model A 2-Stage Regulator |
| AC-5H | 5' UL listed hose with Fittings |
| AC-6H | 6' UL listed hose with Fittings |
| AC-6QD | 6' Quick Disconnect Hose for Natural Gas |
| AC-12QD | 12' Quick Disconnect Hose for Natural Gas |

Oasis Wine Cooler



▲ **Model OWC/FS**
Oasis Wine Cooler



▲ **Model OWC/SSM**
Oasis Wine Cooler

- ◆ Available as Mobile or Free Standing Unit.
- ◆ Includes auto-defrost.
- ◆ Meets commercial NSF-7 standards.
- ◆ Features scalloped wine shelves with room for up to 40 bottles of wine or plenty of extra storage space.
- ◆ Reversible door handle with polished stainless steel handle and UL approved double pane safety glass provides a choice of openings.
- ◆ Adjustable thermostat settings.
- ◆ Plugs into standard GFI 115 volt electrical outlet.

| SPECIFICATIONS | OWC/SSM | OWC/FS |
|-------------------------|----------|----------|
| Height: | 352" | 332" |
| Width: | 58" | 23-0; " |
| Depth: | 29" | 232" |
| Shipping Weight: | 285 lbs. | 100 lbs. |

Wine Cooler Accessories

| MODEL | DESCRIPTION | SHIPPING WEIGHT |
|----------|------------------------|-----------------|
| AC-OWCVC | Vinyl Cover | 9 |
| AC-BS | Scalloped Bottle Shelf | 3 |
| AC-FS | Flat Shelf | 2 |

Oasis Beverage Dispenser



▲ **Model OPBD/SSM**
Oasis Beverage Dispenser



▲ **Model OPBD/FS**
Oasis Beverage Dispenser

- ◆ Holds half kegs or quarter kegs
- ◆ Keeps beer at the ideal temperature.
- ◆ Adjustable thermostat included.
- ◆ Oasis Beverage Systems ship complete, including:
 - CO² tank & regulator.
 - Sankey/American tap.
 - Draft tower for easy pouring.
 - Wooden slats.
 - Top rail to hold cups in.
 - Drip tray to catch spills (not shown).
 - Sturdy casters for easy mobility
- ◆ Stainless Steel model includes side shelves for additional storage.

| SPECIFICATIONS | OPBD/SSM | OPBD/FS |
|----------------------------|----------|----------|
| Finish: | SS | Black |
| Height with Tower: | 51" | 52" |
| Height w/o tower: | 39½" | 40¼" |
| Height w/o toprail: | 37" | 38" |
| Width: | 58" | 23¼" |
| Depth: | 32½" | 26" |
| Shipping Weight: | 300 lbs. | 150 lbs. |

Portable Cooker, Warmer, Server

A completely portable stove which operates on propane gas cylinders approximately 4 to 8 hours, depending on the size of the cylinder. The unit is all Type 304 Stainless Steel construction and is equipped with a piezo-electric push button ignition for easy starting. Utilizing a single stainless steel burner with a three position regulator valve, model CWS accepts both 14.1 oz and 16.4 oz. propane gas cylinders. Propane gas cylinders are not included.

NOTE: Unit uses a 12" x 20" spillage pan for water and any combination cooking or warming pans - **NOT** included with unit.



| SPECIFICATIONS | PCWS |
|-------------------------|---------|
| Length: | 25" |
| Width: | 16½" |
| Height: | 15½" |
| Shipping Weight: | 19 lbs. |

Gas Burners & Valves



#1 cCc



#3 cCc



#5 cCc

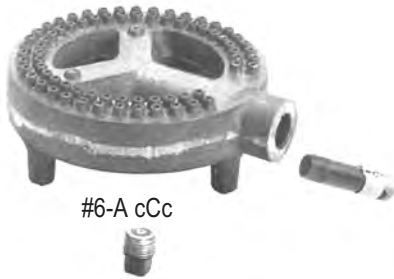

#6-A cCc



#7-A cCc



#12 cCc



#HPB



#125 cCc

| MODEL # | BTU'S | BURNER SIZE | WT. |
|----------|--------|----------------------|-----|
| #1 cCc | 8,000 | 2p" diameter | 2 |
| #3 cCc | 12,000 | 4" diameter | 3 |
| #5 cCc | 20,000 | 5" diameter | 3 |
| #6-A cCc | 22,000 | 6" diameter | 7 |
| #7-A cCc | 28,000 | 7" diameter | 8 |
| #12 cCc | 60,000 | 3 Ring burner | 15 |
| #125 cCc | 30,000 | Loop Burner | 6 |
| HPB | | High Pressure Burner | 3 |



Order by 2 pm Monday through Friday
and Parts Ship same Day

Order On-Line at:
www.lazyman.com

or call us at:
800-475-1950

Gas Valves

| MODEL | VALVE DESCRIPTION | WT. |
|----------|-----------------------------------|-----|
| SLB | Steel Line(1 ft increment per ft) | 2 |
| A - HPV | High Pressure Needle Valve | 1 |
| B - BHV | Black Handle Brass Valve | 1 |
| C - BPC | Brass Pillar Cock | 1 |
| D - BLV | Brass Locking Valve | 1 |
| E - Spud | Orifice Spud | 1 |
| F - Hood | Hood | 1 |
| G - RTV | Range Type Valve | 1 |

