

Model A Series Installation Instructions

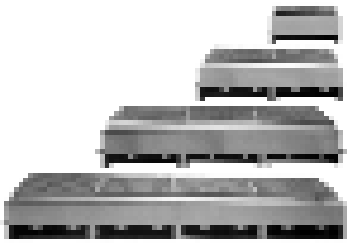

Please follow these instructions carefully. Failure to follow these instructions can result in a very dangerous situation and possibly void your warranty.

- LAZYMAN Grills are for **OUTDOOR USE ONLY**.
- This barbecue **MUST BE** installed in masonry or cinder block construction! Any wood construction **MUST BE** at least 24" away and **NEVER** locate this barbecue under overhead structures. Failure to follow these instructions can result in a very dangerous situation and possibly void your warranty.
- Before installation, be sure to check the type of fuel - Propane or Natural Gas. Units are set for each specific fuel and are not interchangeable. Units not set for the type of gas being used **WILL NOT WORK** and could cause damage. Propane units require the use of a low pressure regulator.
- Fuel delivery system must be black pipe or copper tubing. Hose **CANNOT** be used through masonry or cinder block construction, nor can a hose be used for the final connection to the barbecue.
- Any gas connection should be made by a **QUALIFIED GAS SERVICE TECHNICIAN!** Always safety check all gas connections before lighting any barbecue. **REMEMBER - GAS BURNS AND SO DO LEAKS!** Safety is up to you.
- Upon completion of installation and safety checks, place lava rocks around burners. Coal support grates are **NOT** used in this type of gas barbecue. Place stainless steel cooking grates on top. Ignition of the gas-fired barbecue is accomplished by lighting a long fireplace match and inserting it through the cooking grate and **ONLY THEN** turning on the gas valve. The second burner will be ignited by the first. This **MUST** be done for each section. If barbecue does not light, wait five (5) minutes for gas to disperse and repeat above instructions.
- Cooking is the same as any gas-fired barbecue. Any sauces should be applied toward the end of cooking to eliminate unwanted flare-ups.
- Cleaning the barbecue should be done with oven cleaner or with a mild abrasive soap. Once a year the burners should be removed and cleaned.



LAZY MAN, INC.

P. O.Box 327, 616 Hardwick St. • Belvidere, NJ 07823

800-475-1950 • 908-475-5315 • Fax: 908-475-3165

www.LazyMan.com • e-mail: LazyManGrills@yahoo.com

Model A Series Installation Instructions

"A" Series Parts List

Note: Only 1 Section Is shown

Part #	Description
A001	Permanent Coals, set
A022	Hot Rod Cooking Grate
A003	Burner Tube
A003SS	SS Burner Tube
A004	Valve with Handle
A005	Pipe Manifold
A006T	SS Front Trim Piece
A007	Burner Pan insert
A009	Drift Pan

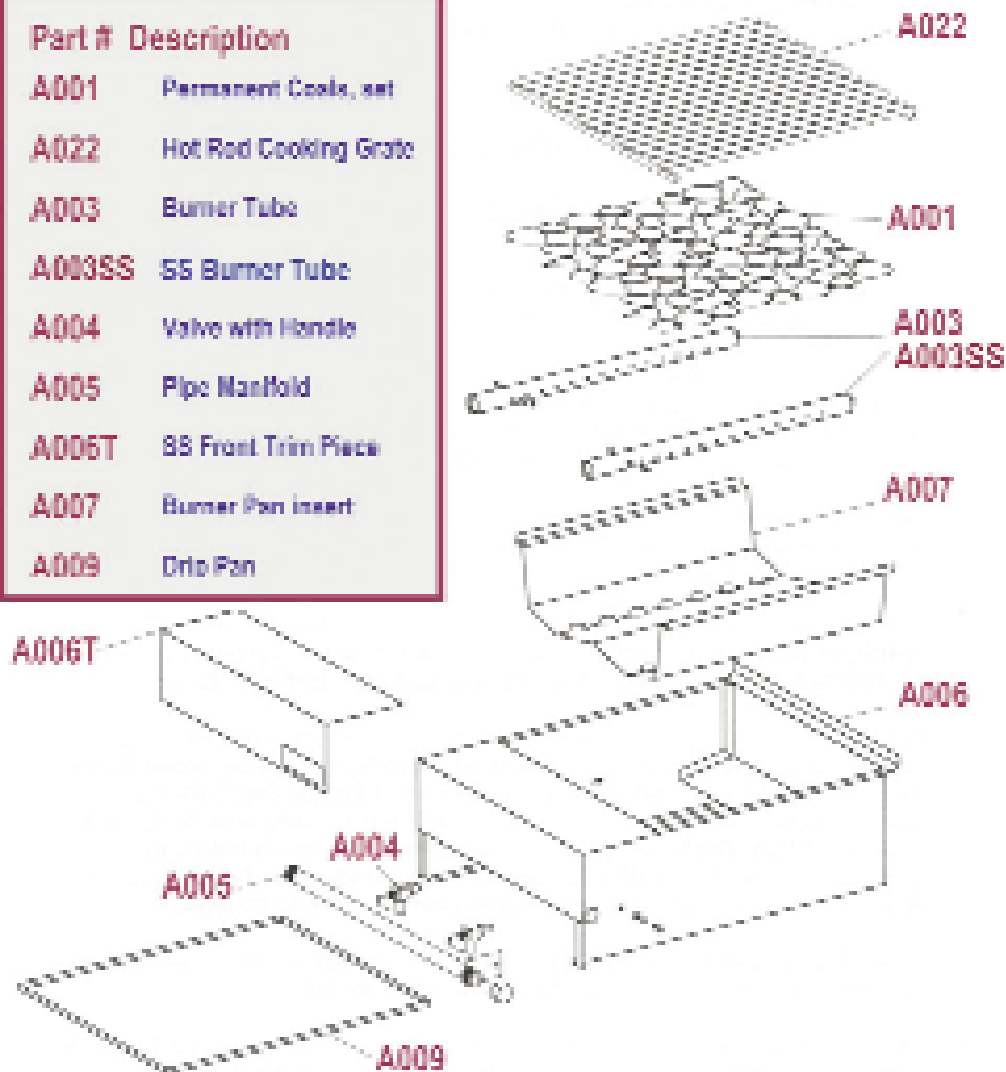

LAZY MAN, INC.

P. O. Box 327, 616 Hardwick St. • Belvidere, NJ 07823

800-475-1950 • 908-475-5315 • Fax: 908-475-3165

www.LazyMan.com • e-mail: LazyManGrills@yahoo.com